



Bonneagar Iompair Éireann
Transport Infrastructure Ireland

TII Publications



Standard Construction Details - Series 1100

April 2017

Standard Construction Details (SCDs) – Series 1100

TII Publications contains Standard Construction Details (SCDs) for use on National Road schemes in Ireland. This composite document brings together all the Series 1100 SCDs from TII Publications current at the date of this document's publication, into a single location for convenience.

Every effort has been made to keep this composite document updated and available from the TII Publications website (<http://www.tiipublications.ie/>). Please note that the SCD drawings available from the TII Publications website (individually linked below) are the controlled versions for all SCDs.

The SCDs contained in this document are as follows:

Series 1100 Kerbs, Footways and Paved Areas

CC-SCD-01101	Kerbs, Footways and Paved Areas - Precast Kerbs
CC-SCD-01102	Kerbs, Footways and Paved Areas - In Situ Concrete Kerb
CC-SCD-01103	Kerbs, Footways and Paved Areas - Dropped Kerb Ramp
CC-SCD-01104	Kerbs, Footways and Paved Areas - Bituminous Footway
CC-SCD-01105	Kerbs, Footways and Paved Areas - Concrete Footway
CC-SCD-01106	Kerbs, Footways and Paved Areas - Non Trafficked Block Paving
CC-SCD-01107	Kerbs, Footways and Paved Areas - Nosing Detail
CC-SCD-01108	Kerbs, Footways and Paved Areas - Typical Paved Roundabout
CC-SCD-01109	Precast Kerbs - Precast Kerb Units
CC-SCD-01110	Kerbs, Footways and Paved Areas: Channelising Island Detail

1. IN SITU CONCRETE KERBS SHALL COMPLY WITH THE RECOMMENDATIONS OF B.S. 5931.

2. KERBS SHALL BE PROTECTED FROM THE EFFECTS OF ADVERSE WEATHER UNTIL CURED.
3. DROP KERB HEIGHT VARIES FROM 25mm FOR VEHICULAR ACCESSES AND 0-6MM FOR PEDESTRIAN CROSSINGS



TII PUBLICATION NUMBER: CC-SCD-01102

TACTILE PAVING:
TACTILE PAVING ON APPROACH
TO PEDESTRIAN CROSSINGS
ARE REQUIRED ON CYCLEWAYS
AND FOOTWAYS

VEHICULAR ACCESS:
RAMP CONSTRUCTED FROM GRADE
C30 CONCRETE 150mm THICK
WITH A393 MESH REINFORCED
TOP AND BOTTOM. SURFACE OF
RAMP TO BE BRUSHED TOP FROM
'NON-SLIP' FINISH.

PEDESTRIAN CROSSINGS:
TACTILE PAVING TO BE PROVIDED TO
GIVE GUIDANCE TO VISUALLY
IMPAIRED PEDESTRIANS.

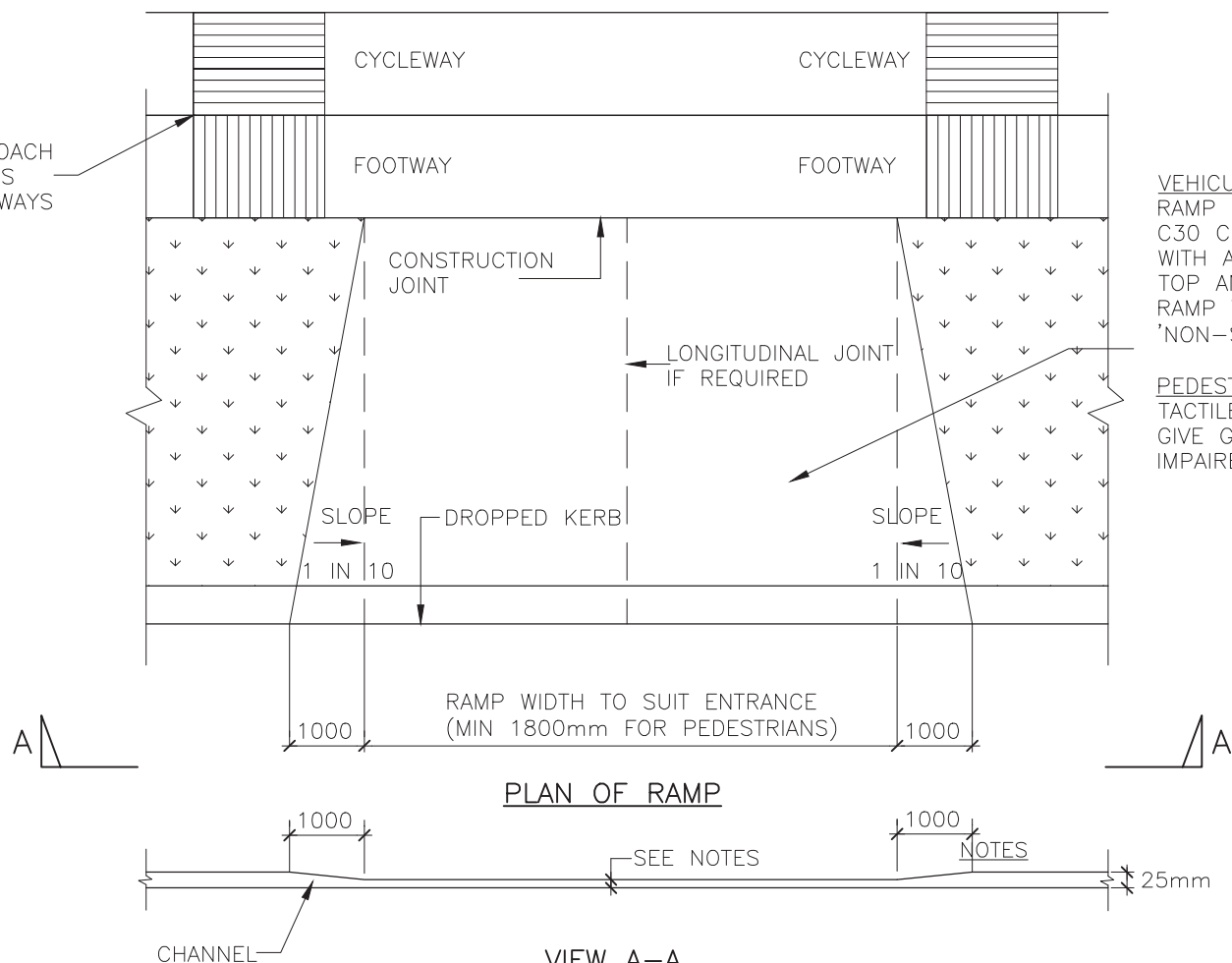

1. A RAISED LIP OF 25mm SHOULD BE USED FOR VEHICULAR ENTRANCES.
2. A RAISED LIP OF 0 – 6mm SHOULD BE USED FOR PEDESTRIAN CROSSINGS.
3. REFER TO RCD/1100/9 FOR PRE-CAST KERB DIMENSIONS
4. REFER TO RCD/1100/2 FOR IN-SITU CONCRETE KERB DIMENSIONS.
5. TACTILE PAVING IS TO BE PROVIDED AT ALL PEDESTRIAN CROSSINGS, ADVICE ON THE EXACT LOCATION AND DIMENSIONS CAN BE FOUND FROM THE UK DEPARTMENT FOR TRANSPORT, MOBILITY INCLUSION UNIT DOCUMENT, "GUIDANCE ON THE USE OF TACTILE PAVING"

TII PUBLICATION NUMBER: CC-SCD-01103

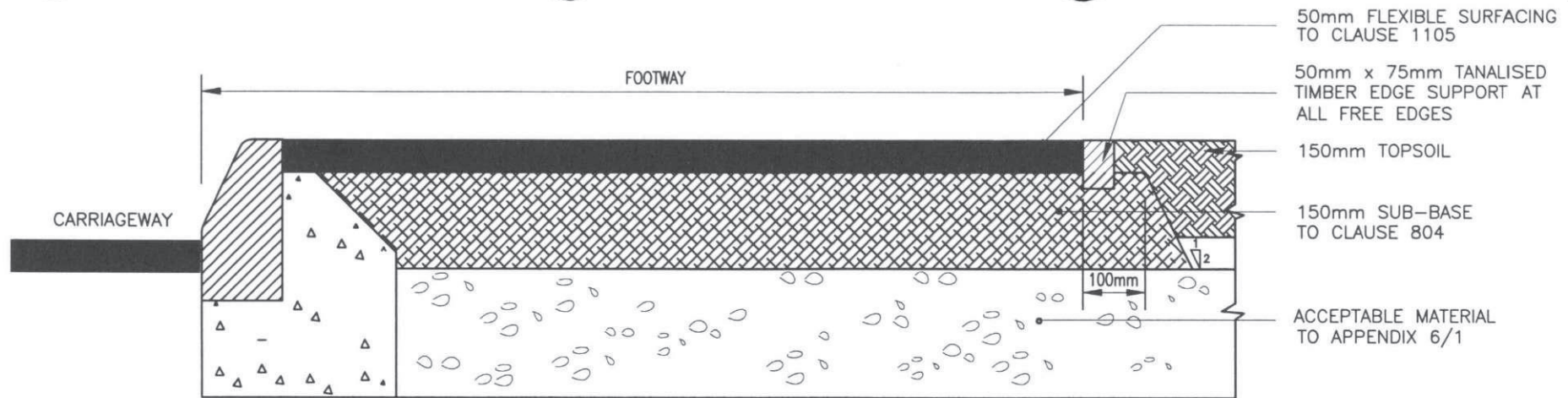

TYPE 1

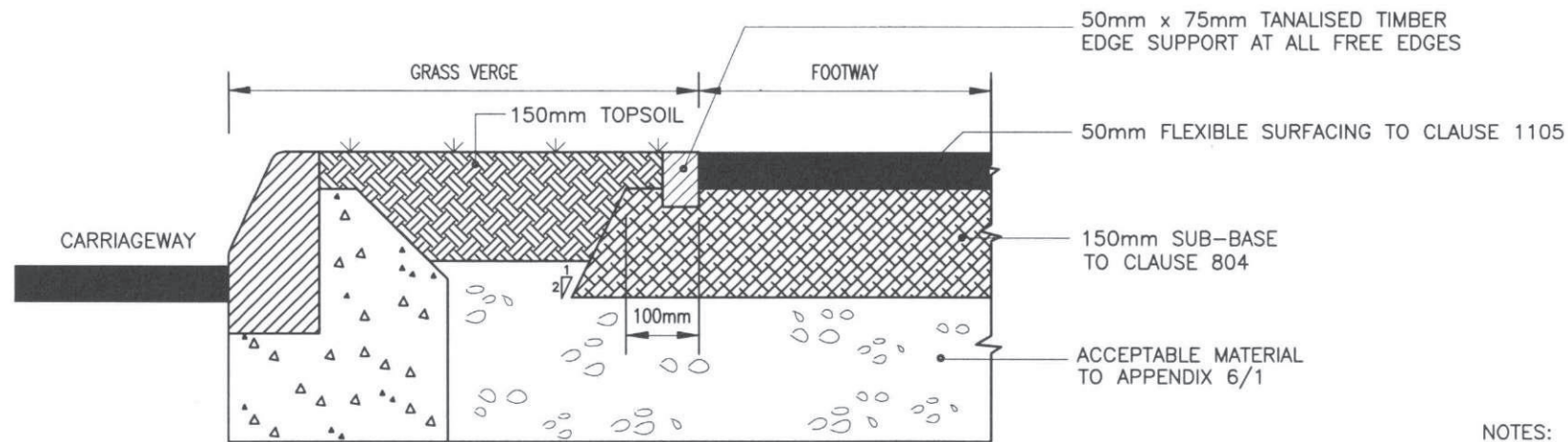

TYPE 2

NOTES:

1. FOOTWAY IS SHOWN WITH A PRECAST CONCRETE KERB TYPE A. ALTERNATIVE KERB TYPES ARE SHOWN RCD/1100/1 AND RCD/1100/2.

TII PUBLICATION NUMBER: CC-SCD-01104

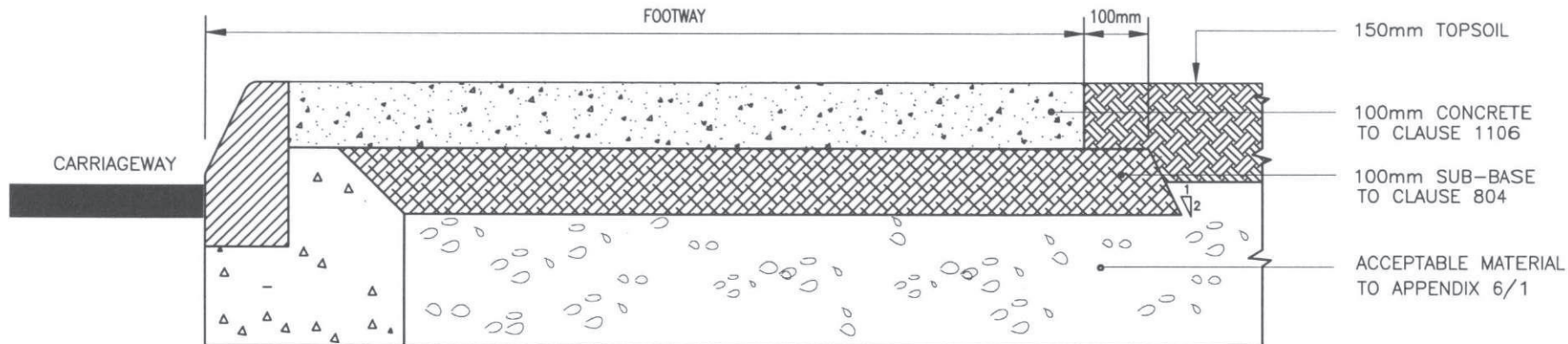

TYPE 1

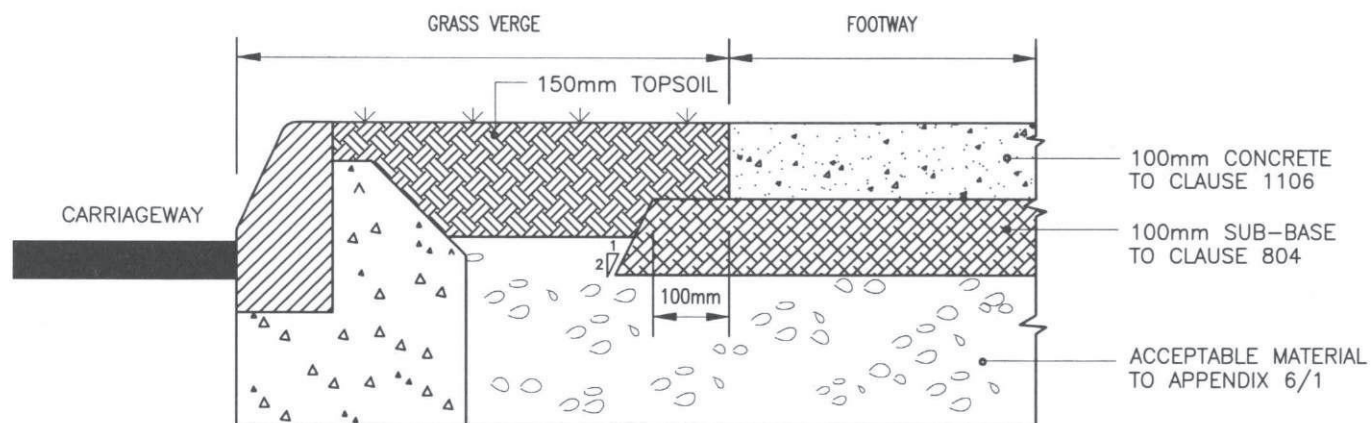

TYPE 2

NOTES:

1. FOOTWAY IS SHOWN WITH A PRECAST CONCRETE KERB TYPE A. ALTERNATIVE KERB TYPES ARE SHOWN ON RCD/1100/1 AND RCD/1100/2.
2. AT VEHICULAR ACCESS POINTS CONCRETE TO BE REINFORCED WITH A393 MESH REINFORCEMENT TOP AND BOTTOM.
3. ALL CONCRETE EDGES AND JOINTS SHALL BE BULLNOZED WITH A TROWEL.

TII PUBLICATION NUMBER: CC-SCD-01105

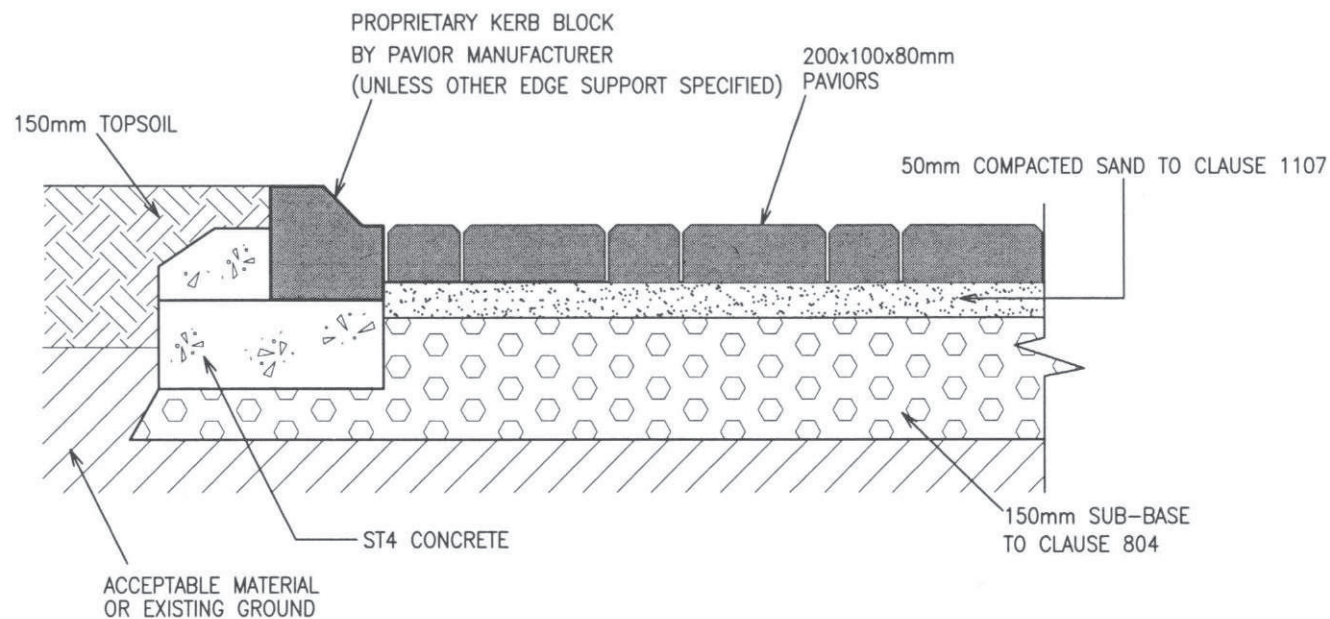

NOTES:

1. ALL BLOCK PAVING FREE EDGES SHALL BE SUPPORTED BY PROPRIETARY KERB BLOCKS UNLESS OTHER EDGE SUPPORT HAS BEEN SPECIFIED.
2. MAXIMUM GRADIENT TO WHICH BLOCK PAVING CAN BE LAID IS 8%.

TII PUBLICATION NUMBER: CC-SCD-01106

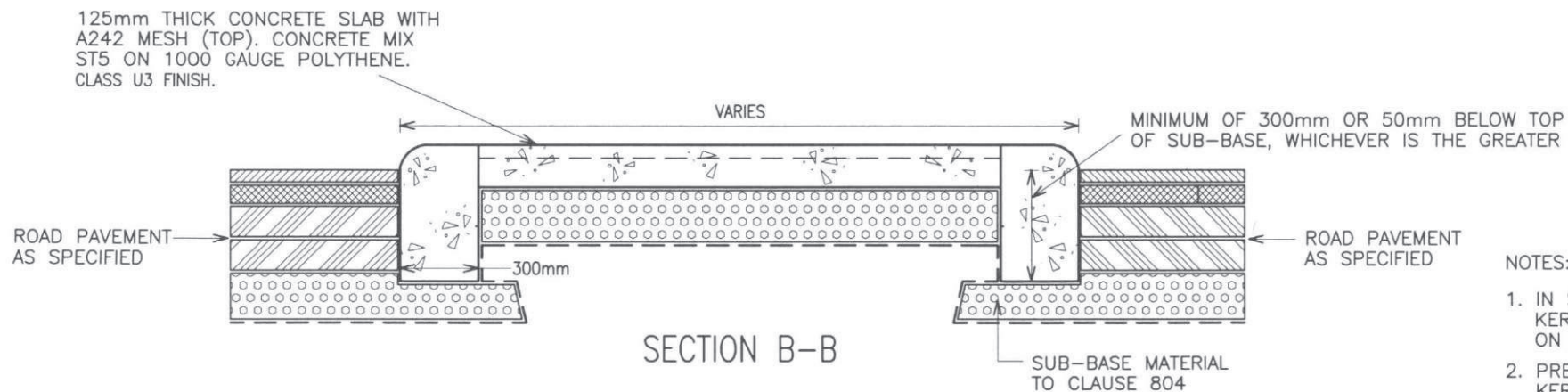
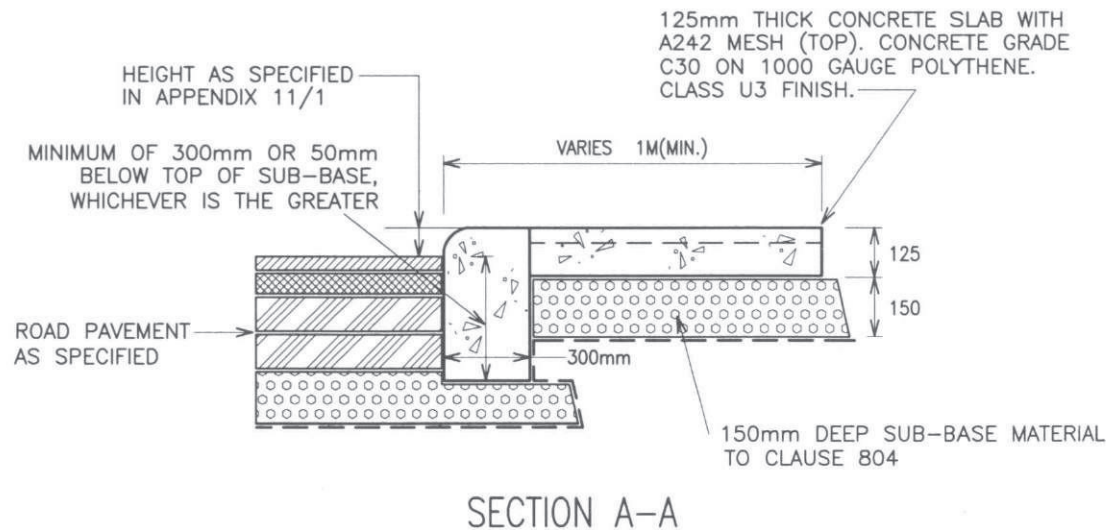
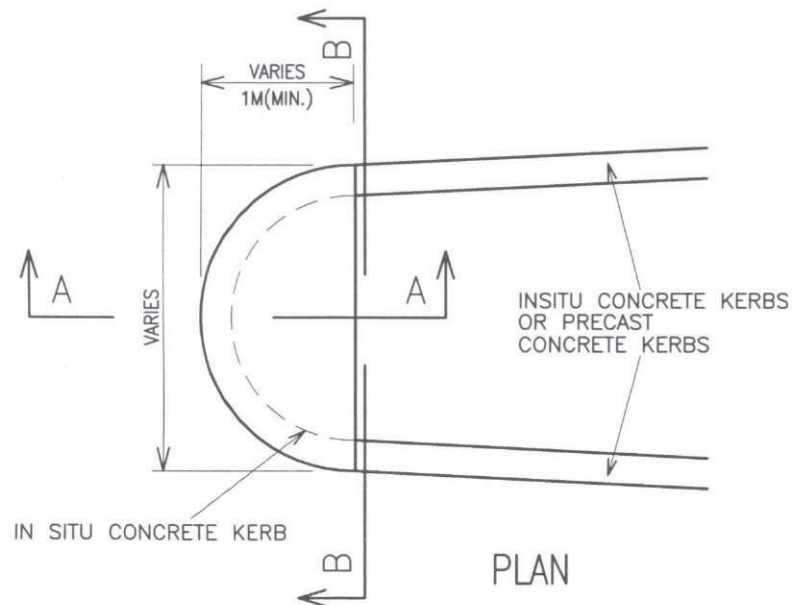

NOTES:

1. IN SITU CONCRETE KERBS ARE AS SHOWN ON RCD/1100/2.
2. PRECAST CONCRETE KERBS ARE AS SHOWN ON RCD/1100/1.

II PUBLICATION NUMBER: CC-SCD-01107

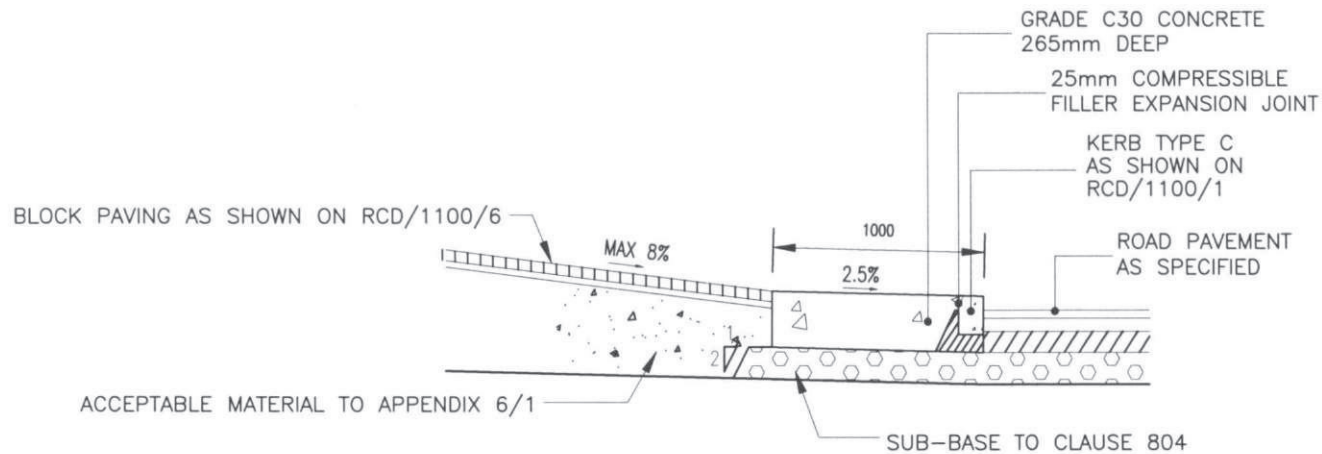

DETAIL

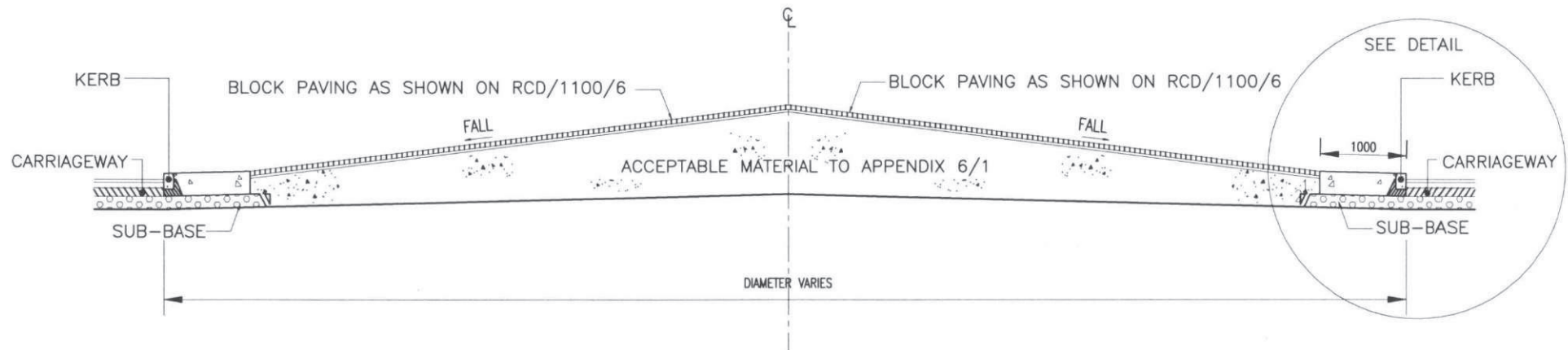

NOTES:

1. ALL DIMENSIONS ARE IN MILLIMETRES
2. DETAIL IS SHOWN WITH A PRECAST KERB TYPE C. ALTERNATIVE KERB TYPES ARE SHOWN IN RCD/1100/1 AND RCD/1100/2.

TII PUBLICATION NUMBER: CC-SCD-01108

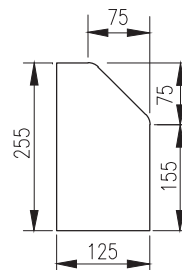

TYPE 1

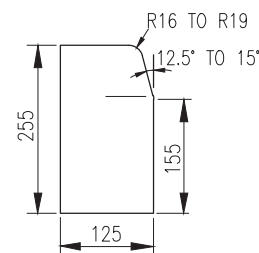

TYPE 2

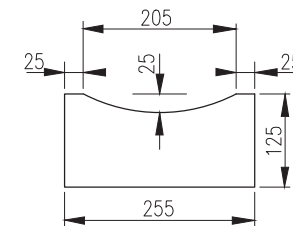

TYPE 3

SCALE 1:250

NOTES:

1. ALL DIMENSIONS ARE IN MILLIMETRES.
2. PRECAST KERBS SHALL BE LAID AND LEVELLED IN ACCORDANCE WITH B.S. 7533 : PART4.
3. A RAISED LIP OF 25mm SHOULD BE USED FOR VEHICULAR ENTRANCES
4. A RAISED LIP OF 0-6mm SHOULD BE USED FOR PEDESTRIAN CROSSINGS
5. PRECAST CONCRETE KERB UNITS SHALL COMPLY WITH IS EN 1340

NOTES :-

1. CHANNELISING ISLAND IS SHOWN WITH PRECAST CONCRETE KERB TYPE A. ALTERNATIVE KERB TYPES ARE SHOWN ON CC-SCD-01101 AND CC-SCD-01102.
2. SHAPE AND DIMENSION OF CHANNELISING ISLAND VARY. SEE DN-GEO-03060 GEOMETRIC DESIGN OF JUNCTIONS FOR DESIGN OF CHANNELISING ISLAND.

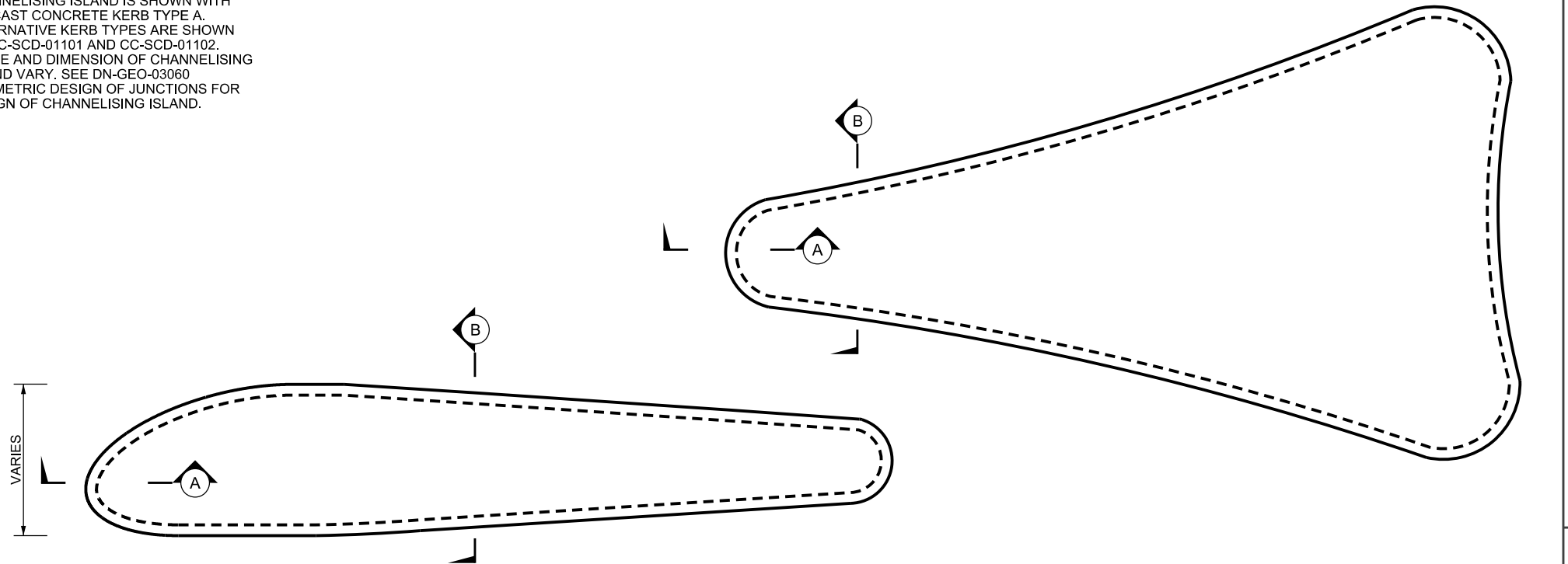

MINIMUM OF 300mm OR 50mm BELOW TOP OF SUBBASE WHICHEVER IS THE GREATER HEIGHT AS SPECIFIED IN APPENDIX 11/1

ROAD PAVEMENT AS SPECIFIED

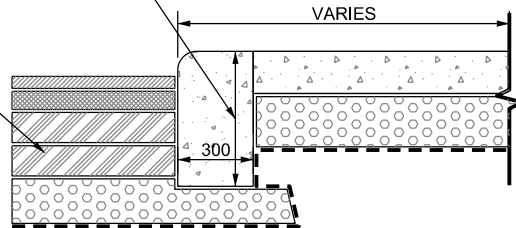

SECTION A

MINIMUM OF 300mm OR 50mm BELOW TOP OF SUBBASE WHICHEVER IS THE GREATER HEIGHT AS SPECIFIED IN APPENDIX 11/1

ROAD PAVEMENT AS SPECIFIED

SUBBASE MATERIAL TO CLAUSE 804

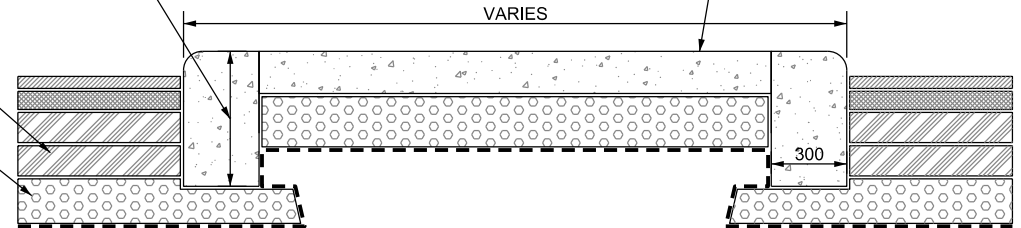

SECTION B



Ionad Ghnó Gheata na Páirce,
Stráid Gheata na Páirce,
Baile Átha Cliath 8, D08 DK10, Éire



www.tii.ie



+353 (01) 646 3600



Parkgate Business Centre,
Parkgate Street,
Dublin 8, D08 DK10, Ireland



info@tii.ie



+353 (01) 646 3601